

GENERAL ARRANGEMENT M. V. COUGAR ACE

FRONT VIEW

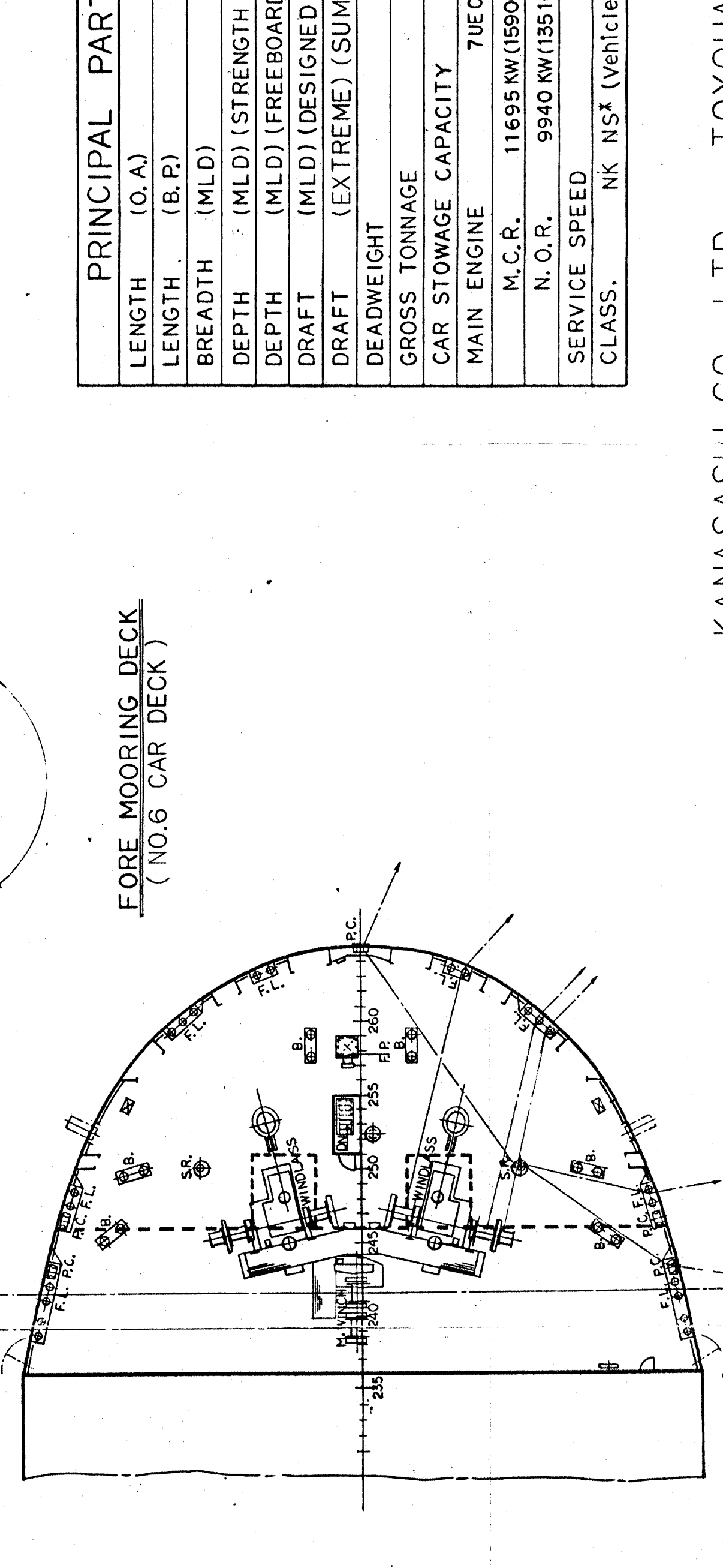
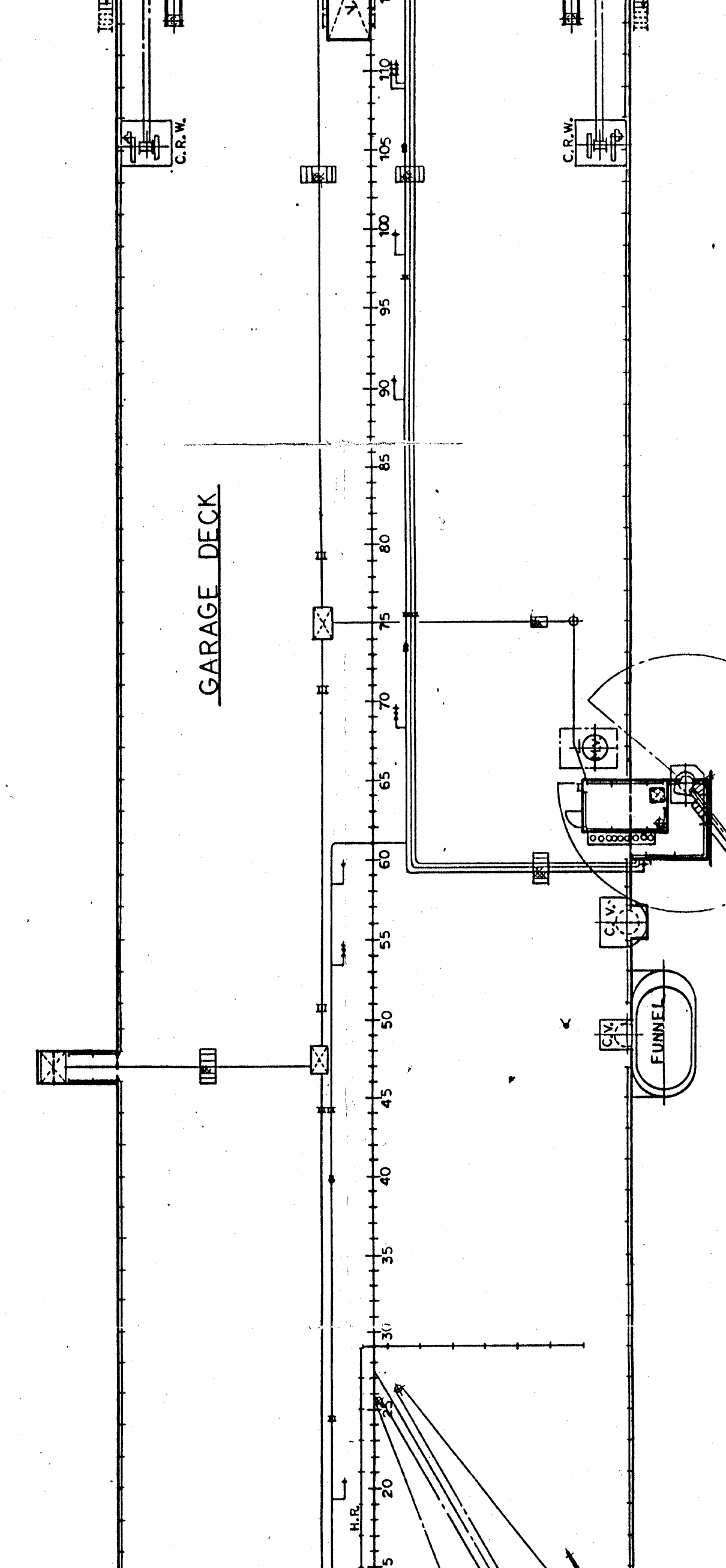
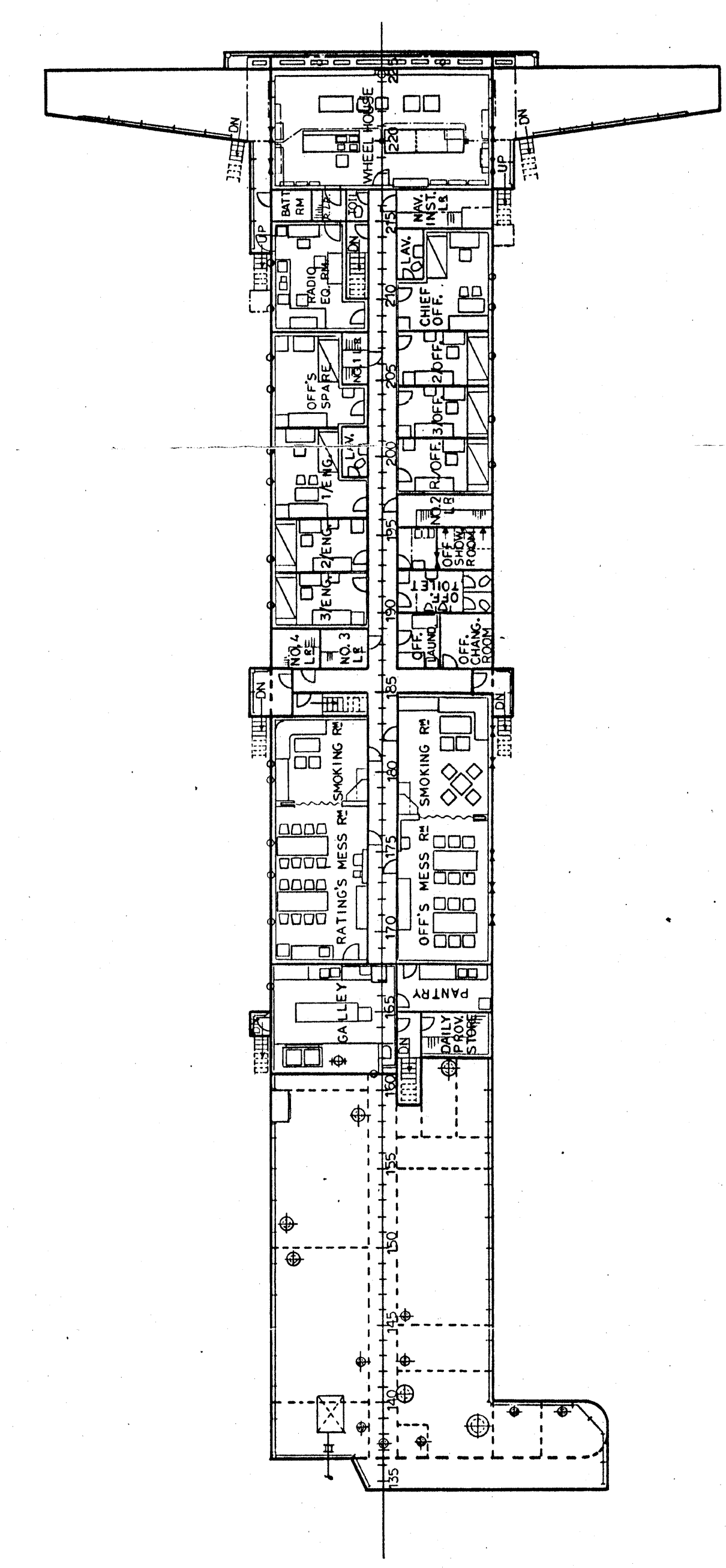
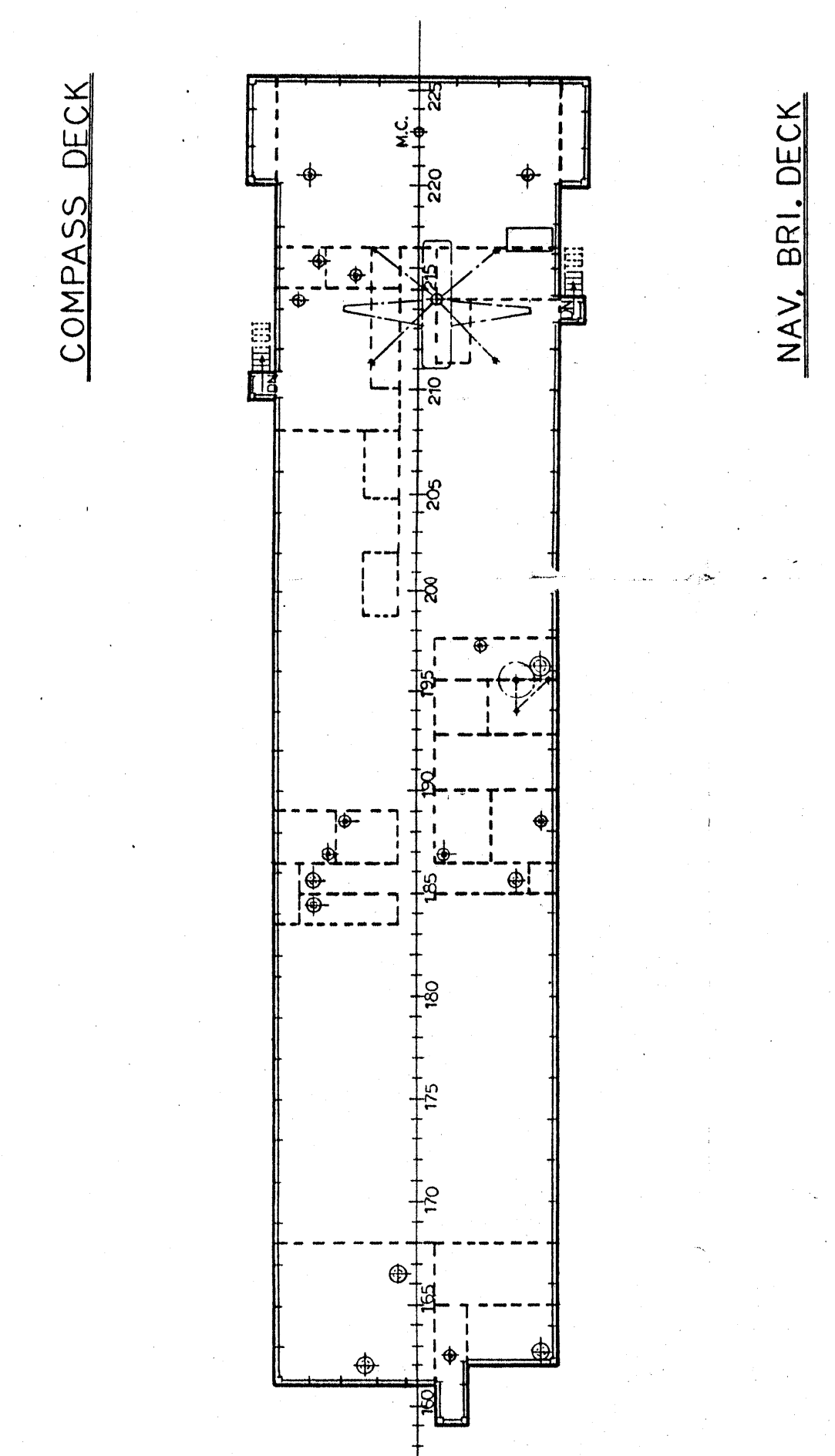
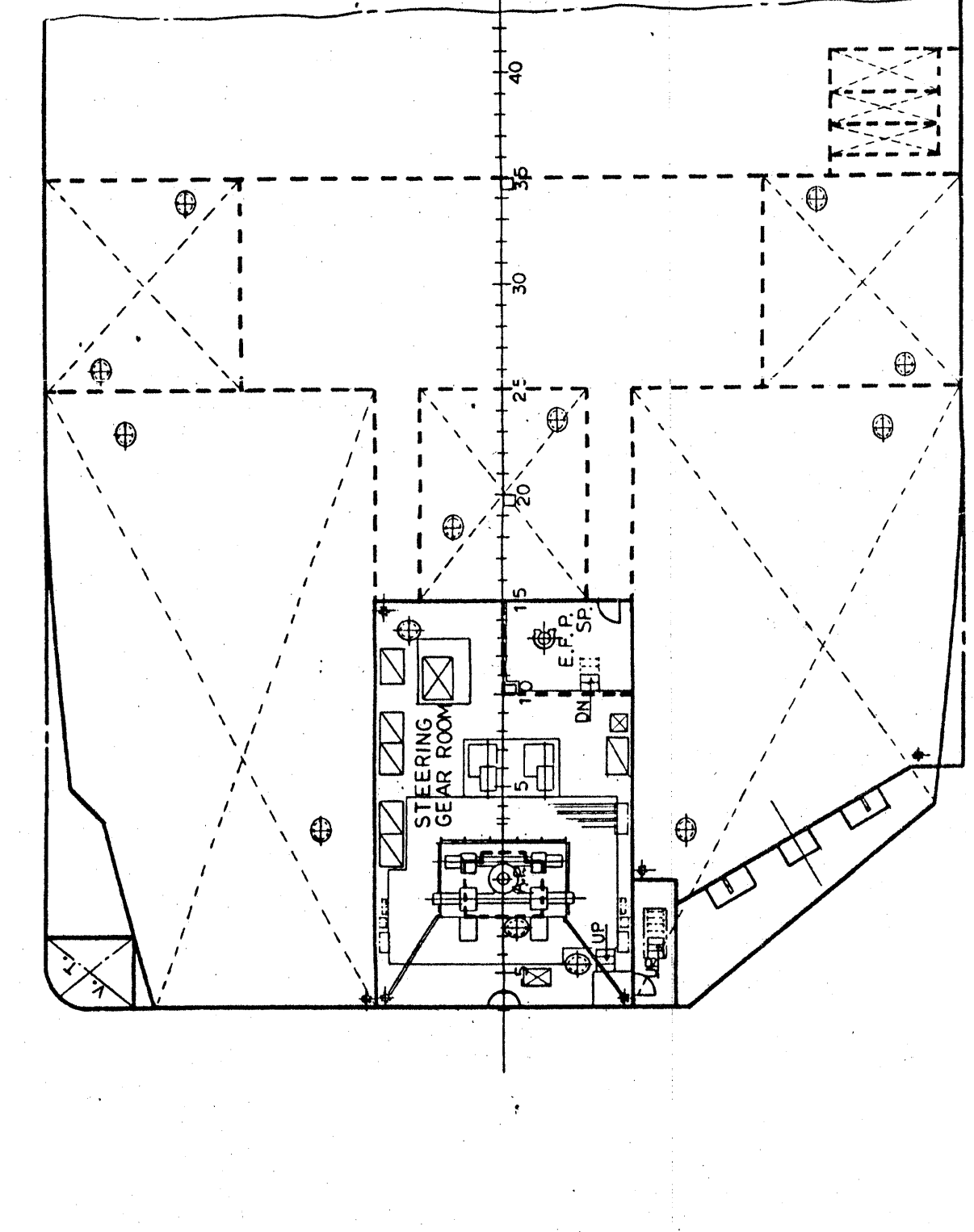
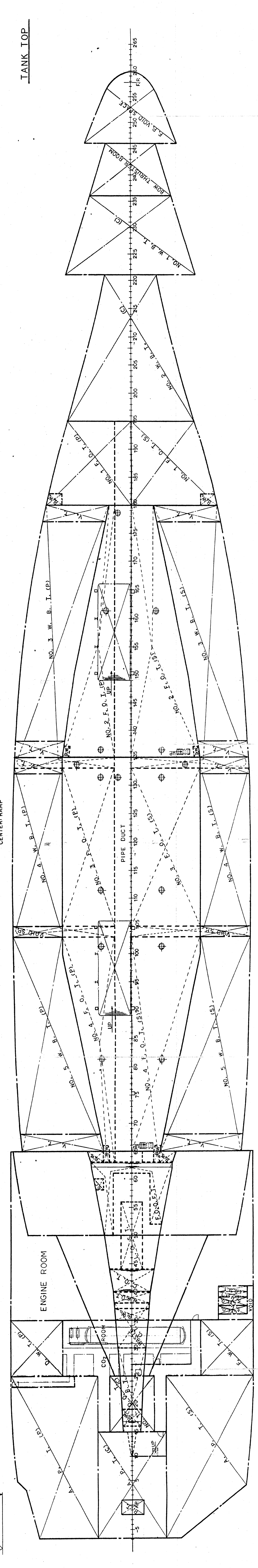
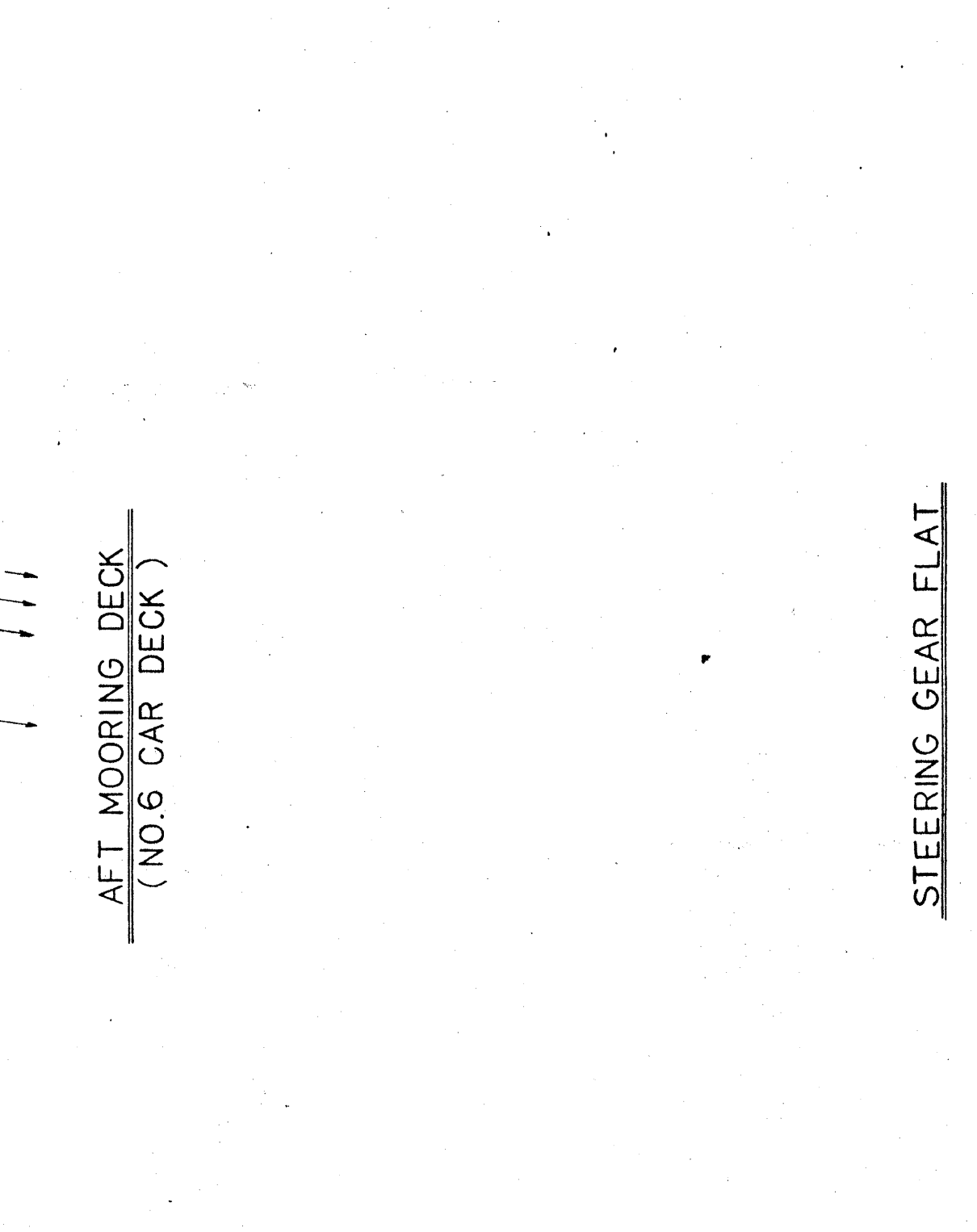
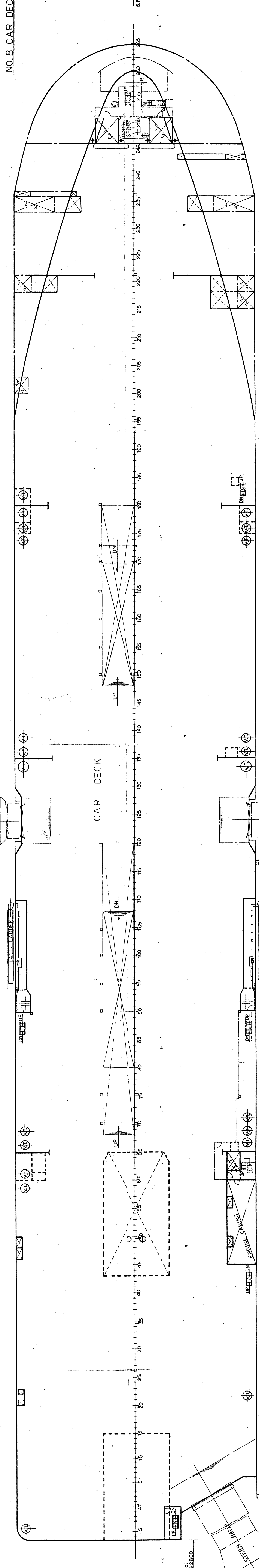
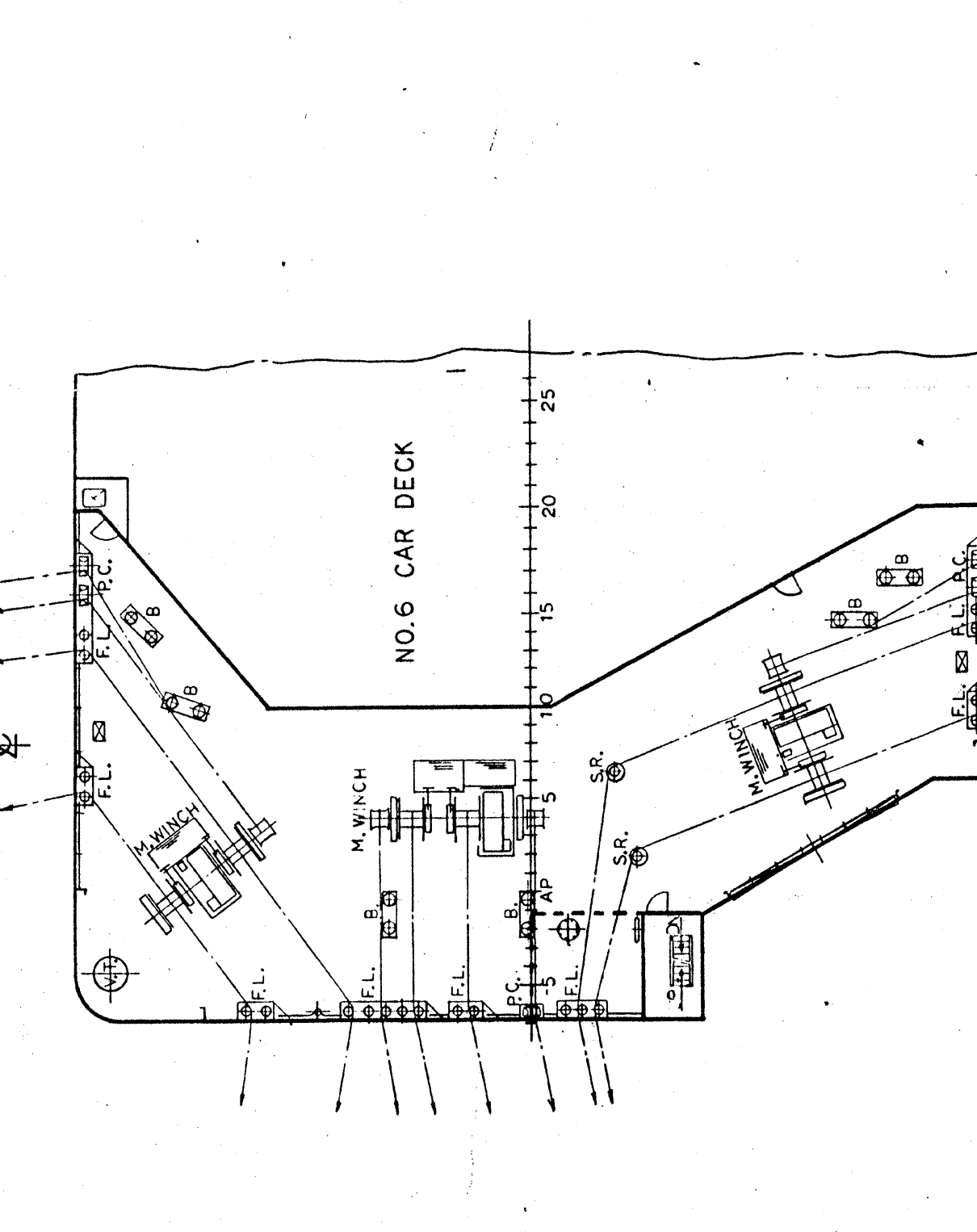
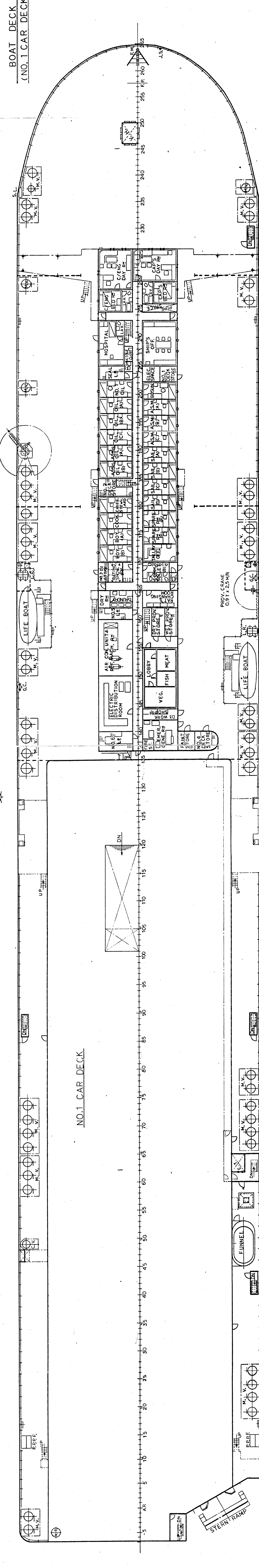
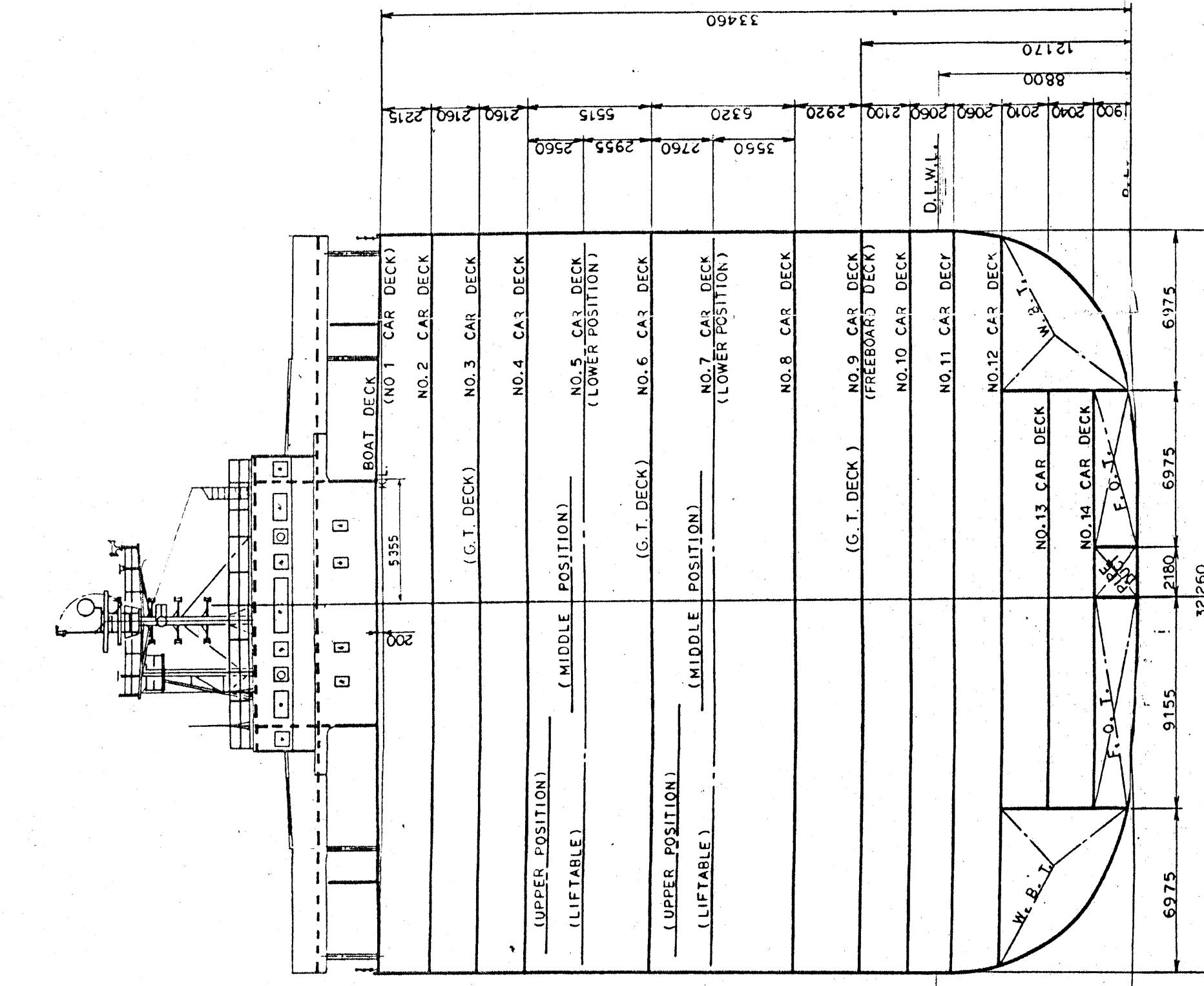
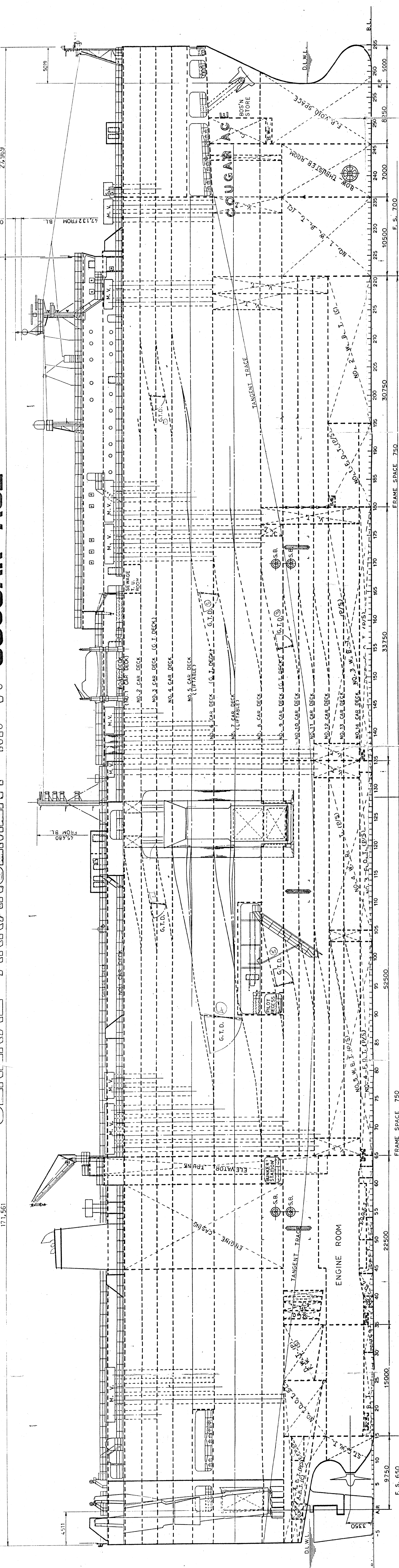

PRINCIPAL PARTICULARS

LENGTH (O.A.)	194.55 m
LENGTH (B.P.)	190.00 m
BREADTH (M.L.D.)	32.26 m
DEPTH (M.L.D.) (STRENGTH DECK)	32.46 m
DEPTH (M.L.D.) (FREEBOARD)	12.17 m
DRAFT (M.L.D.) (DESIGNED)	9.30 m
DRAFT (EXTREME) (SUMMER)	9.724 m
DEADWEIGHT	18222 MT
GROSS TONNAGE	5522 GRT
NET TONNAGE	3222 GRT
MAX. ENGINE CAPACITY	7160 CVT x 1 SET
N.C.R.	11695 KW (15900 PS) x 96 RPM
SERVICE SPEED	18.6 KNOTS
CLASS	NK NS' (VESSELS CERTIFIED) MKS' MO'

COUGAR ACE
SN. 3305

GENERAL ARRANGEMENT

MANAGER: *A. Higashi*
 CHECKED: *T. Yamashita*
 DRAWN: *T. Yamashita*
 DATE: 22. 11. 73
 DESIGNED BY: *T. Yamashita*
 KANASASHI CO., LTD.
 DESIGNING DEPARTMENT
 UNIT: 227, 18, 732

8-VH

KANASASHI CO., LTD. TOYOHASHI WORKS

HA-3